

Hockey Puck Elements

5 - 425 m³/h Flow Range

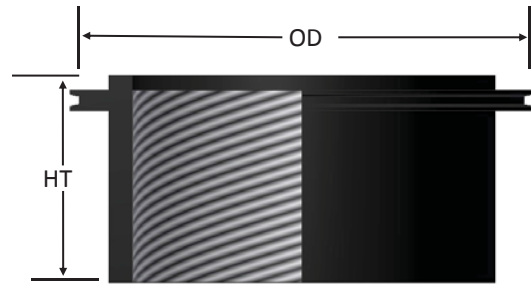

Features

- Patented high grade filter element
- Element construction of injection molded thermoplastic
- Integrated gasket seal
 - Positive seal between housing hemispheres
 - New seal with each element
 - Minimizes parts
- Optimal surface area per given size
- Pleated media for high dirt holding capacity

Technical Specifications

- Temp (continuous): min -26°C (-15°F) max 104°C (220°F)
- Filter change out differential: 37-50 mbar over initial ΔP
- Polyester: 99+% removal efficiency std. to 25 micron
- Paper: 99+% removal efficiency std. to 2 micron

Options

- Contact factory

Polyester Media Benefits/Specs

- Less maintenance due to longer durability
- Moisture resistant
- Handles hot air and oil mist from unload cycle of reciprocating/piston compressor
- Washable with lukewarm water and mild detergent
(Replacing element is recommended)

Paper Media Benefits/Specs

- Heavy duty industrial strength paper
- Cost effective
- Gently blow out media
(Replacing element is recommended)

Tidbit: Charlie Solberg Jr. created a patented process to manufacture our Hockey Puck Style Filter Elements.

Element Part Number		Element m ³ /h Rating	Surface Area m ²	Dimensions - mm	
Polyester	Paper			OD	HT
03	02	5	0.009	38	25
05	04	14	0.019	57	25
07	06	20	0.054	76	35
11	10	60	0.10	102	35
17*	16	425	0.74	191	83

* = Minimum order quantity applies

See Element Technical Data section for maintenance guidelines

Note: Model offerings & design parameters may change without notice.

Ross Brown Sales Pty. Ltd
 ABN 28 000 690 362
 Phone: (02) 8855 1700 Fax: (02) 9899 4233
 Email: sales@rossbrownsales.com.au
 Website: www.rossbrownsales.com.au